

THE SEAL AND SIGNATURE OF THE REGISTERED PROFESSIONAL ENGINEER ARE REQUIRED ON ALL DRAWINGS AND SPECIFICATIONS BY THE BOARD OF ENGINEERING EXAMINERS OF THE STATE OF TEXAS ON OR AFTER MAY 12, 2008.

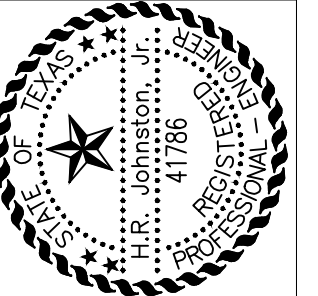

GALEWSKY AND JOHNSTON
CONSULTING ENGINEERS
 1275 N. MAJOR DR. BEAUMONT, TEXAS 77706
 409-866-3707

NO. ISSUED FOR: 5
 DATE: 04-24-09
 OWNER REVIEW: 05-01-09
 BIDS AND CONSTRUCTION: 09001
 FILE # E1
 DATE: 04-24-09

NO.	ISSUED FOR	DATE	DWN	HJ
1	OWNER REVIEW	04-24-09	CHK'D	HJ
2	BIDS AND CONSTRUCTION	05-01-09		
3				
4				
5				

MINNIE ROGERS
JUVENILE JUSTICE CENTER
SURVEILLANCE SYSTEM UPGRADE
 HIGHWAY 69 SOUTH BEAUMONT, TEXAS

SHEET NO. 1
 OF 4
 SET TOTAL

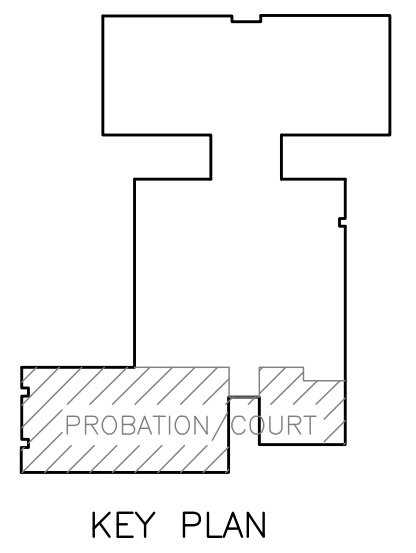

GALEWSKY & JOHNSTON
CONSULTING ENGINEERS, INC.
 TEXAS REGISTERED ENGINEERING FIRM F-2555
 1275 N. MAJOR DRIVE
 BEAUMONT, TEXAS 77706
 (409) 866-3707

OWNERSHIP OF DOCUMENTS
 THIS DOCUMENT, AND THE IDEAS AND DESIGNS INCORPORATED HEREIN, AS AN INSTRUMENT OF PROFESSIONAL SERVICE, IS THE PROPERTY OF GALEWSKY & JOHNSTON CONSULTING ENGINEERS, INC. AND IS NOT TO BE USED, IN WHOLE OR IN PART, FOR ANY OTHER PROJECT WITHOUT WRITTEN AUTHORIZATION OF GALEWSKY & JOHNSTON CONSULTING ENGINEERS, INC.

1 SECURITY PLAN - PROBATION/COURT
 SCALE : 1/8" = 1'-0"

