

**SOUTHEAST TEXAS
REGIONAL AIRPORT**

**JEFFERSON COUNTY
TEXAS**



**ARCENEAUX
&
GATES**
CONSULTING ENGINEERS, INC.
PORT ARTHUR, TEXAS

DMJM AVIATION | AECOM

NO.	DESCRIPTION	DATE	BY

FAA APPROVAL STAMP

**FEDERAL AVIATION ADMINISTRATION
SOUTHWEST REGION**

ALP APPROVED
 ALP APPROVED - SUBJECT TO CONDITIONS/
 COMMENTS IN LETTER DATED
12/06/07
 AERONAUTICAL STUDY NO. 2007-ASW-
994-N2A
 DISTRIBUTION: FTW FPO (3) ASW-470 (1) ASW-520 (2)
 TXDOT (1)
Benj. H. ASW-652
 DATE: 12/6/07 Benj. H. ASW-652
ACT, MANAGER, TX ADO

APPROVAL
 AIRPORT SPONSOR

TITLE AIRPORT SPONSOR'S REPRESENTATIVE

 DATE: 12/7/07

DESIGNER: MJB
 DRAWN BY: TRH/ART
 CHECKED BY: MH
 DATE: 7/3/2007

**AIRPORT
LAYOUT DRAWING**

SHEET 2 OF 16

ITEM	EXISTING	ULTIMATE
SERVICE LEVEL	COMMERCIAL	SAME
AIRPORT ROLE	TRANSPORT	SAME
ESTABLISHED AIRPORT ELEVATION	16'	SAME
AIRPORT REFERENCE POINT (ARP)	N 29° 57' 3.0" W 94° 01' 14.53"	SAME
AIRPORT AZIMUTH	1.190	SAME
TEMPERATURE, MEAN MAX, HOTTEST MONTH	92° F	SAME
TERMINAL NAVIGAS	VORAC, NOB, DME ASR, ATCT, GRS	VORAC, NOB, DME DME, ATCT, GRS
VISUAL AIDS	RD, WIND CONE SEGMENTED CIRCLE	SAME
TAXIWAY LIGHTING	MFL 3.0' EAST (SEPT 2008) C-III	SAME
MAGNETIC DECLINATION		SAME
AIRPORT REFERENCE CODE (ARC)		SAME

NOTES:
 1. PROPERTY WITHIN RUNWAYS RPZS THAT FALLS OUTSIDE THE AIRPORT BOUNDARY IS CURRENTLY ZONED AS A MIXED USE.
 2. THE EXISTING ASR-7 IS TO BE DECOMMISSIONED AND REPLACED BY DASR-11.
 3. DASR-11 AIRPORT EXISTS BUT IS NOT OPERATIONAL.
 DATUM COORDINATES: HORIZONTAL - NAD 1983 STATE PLANE TEXAS SOUTH CENTRAL FIPS 4204 FEET
 VERTICAL - NAVD 1988

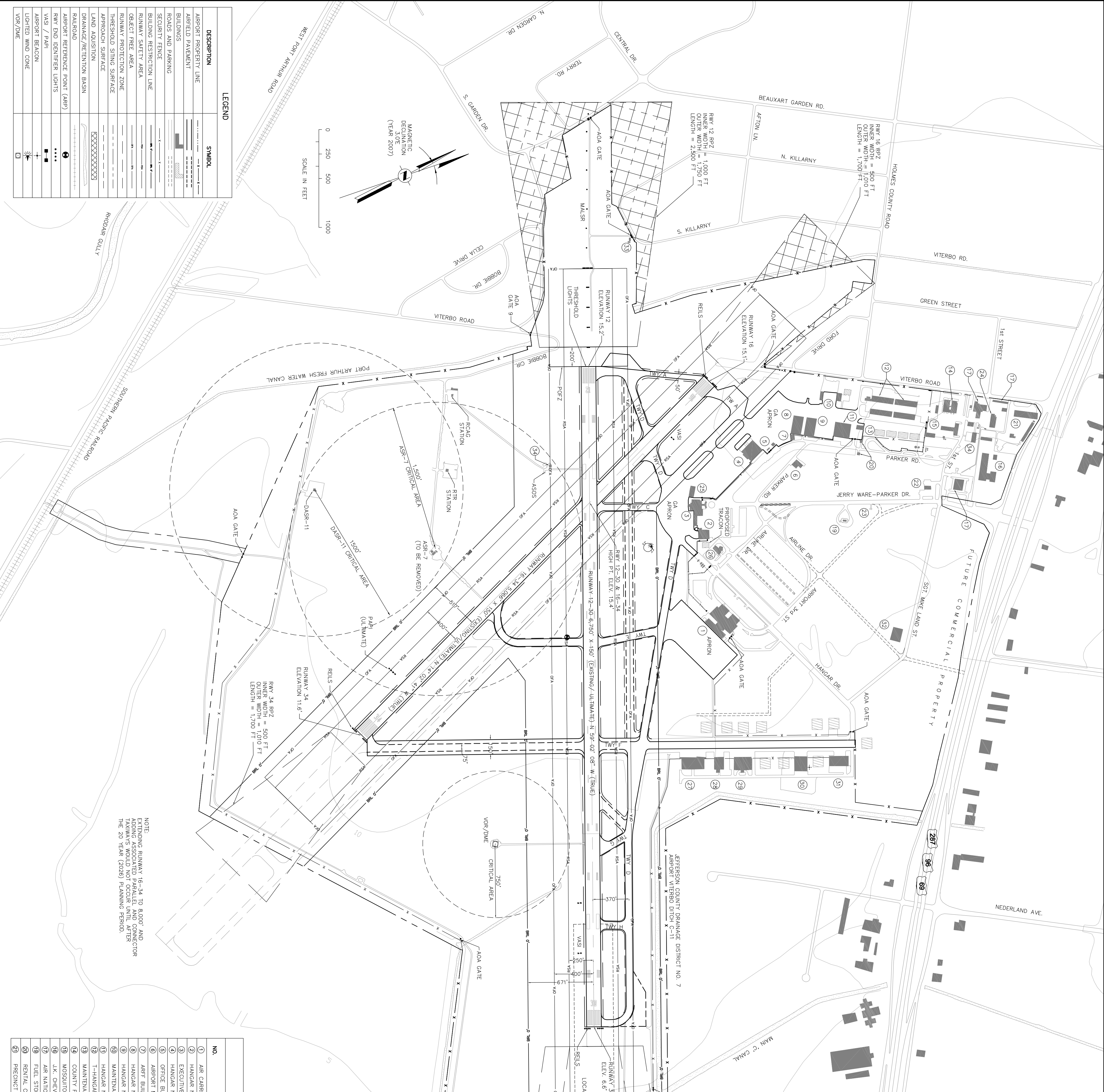

DESCRIPTION	SYMBOL
AIRPORT PROPERTY LINE	---
AIRFIELD PAVEMENT	▨
BUILDINGS	▭
ROADS AND PARKING	▭
SECURITY FENCE	▭
BUILDING RESTRICTION LINE	---
RUNWAY SAFETY AREA	▭
RUNWAY PROTECTION ZONE	▭
THRESHOLD STOP SURFACE	▭
APPROACH SURFACE	▭
LAND ACQUISITION	▭
DRAINAGE/RETENTION BASIN	▭
RAILROAD	▭
AIRPORT REFERENCE POINT (ARP)	●
ASR / PAPI	••••
VAS / PAPI	••••
AIRPORT BEACON	⊕
LIGHTED WIND CONE	⊕
VOR/DME	⊕



NO.	DESCRIPTION	TOP ELEVATION
1	AIR CARRIER PASSENGER TERMINAL	36.00'
2	HANGAR NO. 5	39.10'
3	EXECUTIVE TERMINAL & OLD ATCT	31.00' (61.40' O. TW)
4	HANGAR NO. 1	60.70'
5	OFFICE BUILDING	27.20'
6	AIRPORT MANAGEMENT	21.60'
7	ARFF BUILDING - NOT IN USE	41.20'
8	HANGAR NO. 2	50.30'
9	HANGAR NO. 3	48.60'
10	MAINTENANCE BUILDING	41.00'
11	HANGAR NO. 4	48.10'
12	T-HANGARS	Varies (28' to 31')
13	MAINTENANCE BUILDING	Varies (28' to 44')
14	COUNTY FACILITIES	41.80'
15	MOSSCUTO CONTROL COMMISSION	41.80'
16	J.K. CHEVROLET	35.40'
17	AIR NATIONAL GUARD	32.40'
18	FUEL STORAGE	23.50'
19	RENTAL CAR PREP	25.00'
20	PRECINCT NO. 2 OFFICES	

NO.	DESCRIPTION	TOP ELEVATION
21	TAXI OFFICE	
22	LEFT STATION	
23	PRECINCT #2 BARN	
24	ARFF STATION	29.1'
25	AIRPORT TRAFFIC CONTROL TOWER (ATCT)	128'
26	RE-PAID/MORGAN HANGAR	46'
27	H- AIRCRAFT	24.5'
28	WALTER HUMPHREY HANGAR	
29	AIRPORT LEASD HANGAR	37'
30	COUNTY SHERIFF'S DEPARTMENT	26'
31	NOBLE ENERGY HANGAR	
32	FAA BUILDING	
33	GLIDE SLOPE	52' (ANTENNA)

NOTE:
 DURING RUNWAY 16-34 TO 8,000' AND
 ADDING ASSOCIATED PARALLEL AND CONNECTOR
 TAYMAY'S WOULD NOT OCCUR UNTIL AFTER
 THE 20 YEAR (2020) PLANNING PERIOD.