

SYMBOLOLOGY LEGEND

○ - FIRE HYDRANT - SPEC TO BE DETERMINED

○ - (2) BRASS 3/4" HOSE BIBS, TEE FROM 3/4" UP

FIELD ROUTE ALL WATER PIPING UP PILE @ PANEL BB AND OVERHEAD AS NECESSARY. ALL PIPE TO BE SUPPORTED PER MANUFACTURER'S RECOMMENDATION. OVERHEAD PIPE SHALL BE PVC WITH EXPANSION JOINTS AS NECESSARY AND SUPPORTED WITH CORROSION RESISTANCE METHODS.

⊗ - VALVE

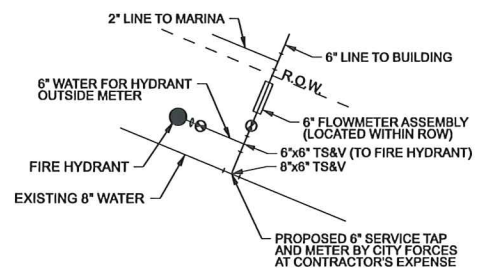

02 CONNECTION TO EXISTING WATER
SCALE: NTS

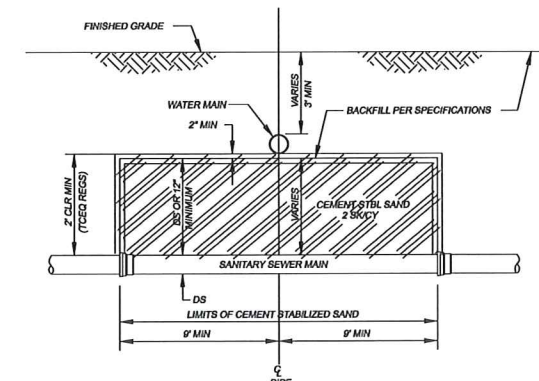
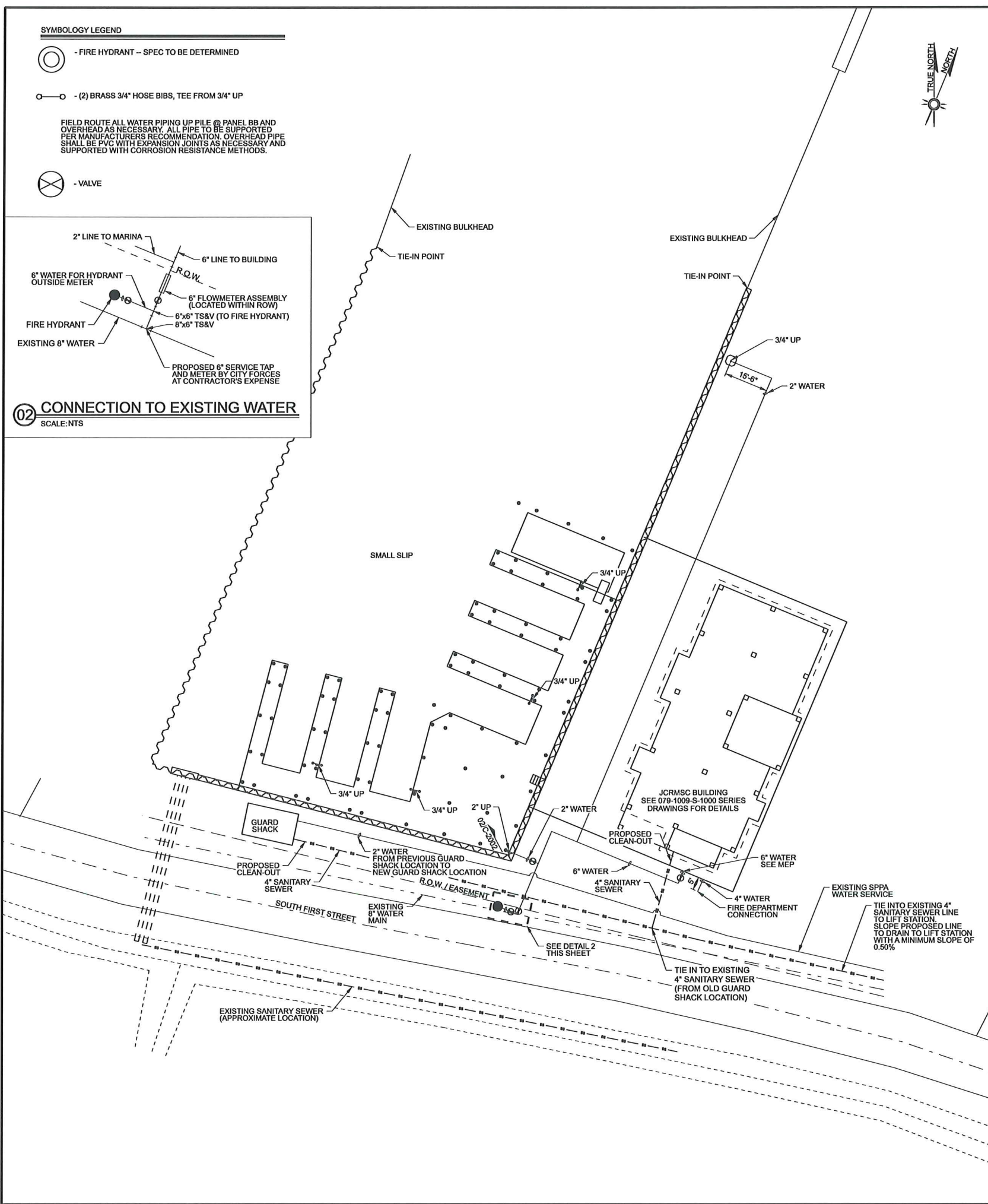

PROTECTION REQUIREMENTS AT WATER LINE - SANITARY SEWER CROSSINGS

PRIMARY CONDITION	PROPOSED WATER EXISTING SANITARY		PROPOSED WATER PROPOSED SANITARY OR EXISTING WATER PROPOSED SANITARY	
	WATER OVER SANITARY	WATER UNDER SANITARY	WATER OVER SANITARY	WATER UNDER SANITARY
IF THE CLEARANCE IS	LESS THAN 2'	Greater than or equal to 2' but less than 9'	LESS THAN 2'	Greater than or equal to 2' but less than 9'
PROTECTION REQUIREMENT	1,2,3	2	0	4
			1,3,5	2
			1,3,5	5

PROTECTION REQUIREMENTS FOR SANITARY SEWER CROSSINGS

(UNLESS VARIANCE IS GRANTED BY TCEQ)
(ALL CLEARANCES SHALL BE MEASURED FROM OUTSIDE WALL TO OUTSIDE WALL)

1. PLACE ONE FULL SECTION OF APPROVED RESTRAINED JOINT WATER LINE CENTERED AT SANITARY SEWER. NOT APPLICABLE FOR EXISTING WATER.
2. IF NO EVIDENCE OF SANITARY SEWER LEAKAGE, PLACE ONE FULL SECTION OF WATER LINE CENTERED OVER SANITARY SEWER; IF THERE IS EVIDENCE OF LEAKAGE, USE NOTE 4 BELOW.
3. ONE FOOT MINIMUM CLEARANCE.
4. AUGER 9" MINIMUM EACH SIDE OF SANITARY SEWER. PLACE ONE FULL SECTION OF WATER LINE, CENTERED UNDER SANITARY SEWER. FILL AUGERED HOLE WITH BENTONITE/CLAY MIXTURE. IF SEWER LINE IS LEAKING, SEWER LINE SHALL BE REPLACED WITH 150 PSI LINED DUCTILE IRON OR PVC PIPE WITH APPROPRIATE ADAPTERS ON ALL PORTIONS OF THE SANITARY SEWER WITHIN 9' OF WATER LINE. PROVIDE RESTRAINED JOINTS FOR BOTH WATER AND SANITARY SEWER LINES AT EACH END OF PIPE SECTION. WATER LINE MUST PASS A PRESSURE AND LEAKAGE TEST AS SPECIFIED IN TECHNICAL SPECIFICATIONS. SEWER LINE SHALL PASS INFILTRATION, EXFILTRATION LOW PRESSURE AIR TEST OR LEAKAGE TEST AS SPECIFIED IN TCEQ CHAPTER 317.2 DESIGN CRITERIA FOR SEWERAGE SYSTEMS.
5. PLACE MINIMUM ONE FULL SECTION OF SANITARY SEWER, 150 PSI LINED DUCTILE IRON OR PVC PIPE CENTERED AT THE WATER LINE AND PROVIDE RESTRAINED JOINTS FOR BOTH WATER AND SANITARY SEWER LINES AT EACH END OF PROPOSED PIPE SECTION. USE CEMENT-STABILIZED SAND BACKFILL FOR ALL PORTIONS OF THE SANITARY SEWER WITHIN 9' OF THE WATER LINE, AS MEASURED PERPENDICULARLY FROM ANY POINT ON THE WATER LINE TO THE SANITARY SEWER (MIN. 2.5 SACK CEMENT/CY. YD. SAND). THE CEMENT-STABILIZED SAND BEDDING WILL START AT A POINT 6" BELOW THE BOTTOM OF SANITARY SEWER TO 6" ABOVE THE TOP OF SANITARY SEWER AND ONE-QUARTER OF THE PIPE DIAMETER OR 6", WHICHEVER IS GREATER, ON THE SIDE OF THE SANITARY SEWER.
6. NOT ALLOWED.

02 TYPICAL WATER AND SANITARY SEWER MAIN CROSSING DETAIL

SCALE: NTS

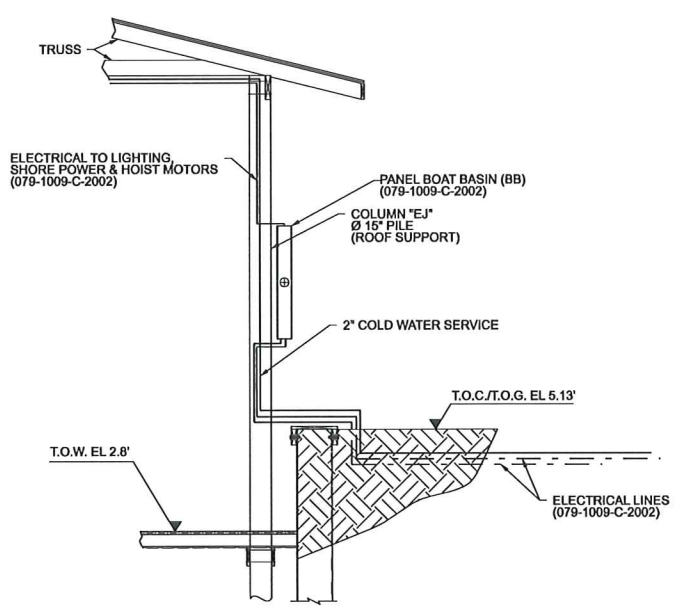

01 SECTION @ PANEL BB
SCALE: NTS

CONFIDENTIAL - RESTRICTED USE

THIS DOCUMENT AND THE IDEAS HEREIN, AS AN INSTRUMENT OF PROFESSIONAL SERVICE, IS THE PROPERTY OF THE ENGINEER & IS NOT TO BE USED IN WHOLE OR IN PART, WITHOUT THE AUTHORIZATION OF LEAP ENGINEERING, LLC.

GENERAL NOTES

- 1 UTILITIES PRESENTED ON THESE DRAWINGS ARE SHOWN BASED ON THE BEST AVAILABLE INFORMATION. CONTRACTOR SHALL VERIFY THE EXACT LOCATIONS IN THE FIELD PRIOR TO COMMENCING CONSTRUCTION.
- 2 CONTRACTOR SHALL NOTIFY "TEXAS ONE CALL" AT (800) 245-4545 AND "LONESTAR ONE CALL" AT (800) 669-6344 AT LEAST 48 HOURS BEFORE PROCEEDING WITH ANY EXCAVATION.



RELEVANT TERMS

- BOC BOTTOM OF CONCRETE
- TOC TOP OF CONCRETE
- TOS TOP OF STEEL
- TOW TOP OF WOOD
- TOG TOP OF GRADE
- FL FLOWLINE
- OC ON CENTER
- OCW ON CENTER EACH WAY

NOTE: THE DRAWING SCALES SHOWN ARE BASED ON 22"x34" SHEET SIZES

LEAP ENGINEERING
905 Orleans St
Beaumont, Texas 77701
Tel: (409) 813-1862
Fax: (409) 813-1916
Texas Registered Engineering Firm F-2601

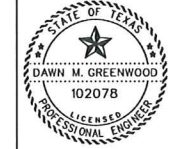

Dawn M. Greenwood
DAWN M. GREENWOOD, P.E. • 102078

ISSUE	DATE	BY	DESCRIPTION	CHKD	APPD
1	11/21/11	JWB	ISSUED FOR CONSTRUCTION	HER	DMG
0	10/17/11	DMG	ISSUED FOR CONSTRUCTION	HER	RCH



JEFFERSON COUNTY

JEFFERSON COUNTY REGIONAL MARINE SECURITY CENTER
AT SABINE PASS PORT AUTHORITY
SANITARY SEWER & POTABLE WATER SERVICE

DRAWN BY	DATE	SCALE	CHKD	HER
DTC	7/19/11	1" = 20'	APPD	DMG
DRAWING NO.	079-1009-C-2003		ISSUE NO.	1